



Figure 1: Elstein Terminal Clamp AK

Elstein Terminal Clamp AK enables a safe, reliable and temperature resistant connection of Elstein Infrared Heaters with the power source.

They are bipolar and consist of a steatite socket as well as stainless steel components. The terminal clamp is designed for wires cross-section of max. 2.5 mm<sup>2</sup> and they get fixed by using an enclosed tapping screw on the mounting profile in the wiring compartment.

For rail wiring with AK, the metal components can be removed by the customer. Then the steatite socket and the separate metal parts are usable for the rail wiring, accordingly.

## Drawing AK

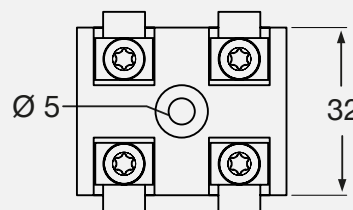
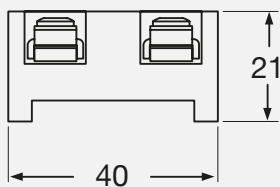

## Technical Data

Maximum Voltage 480 V

Maximum Current 20 A

Maximum Temperature 500 °C

For wires cross-section max. 2.5 mm<sup>2</sup>

Tightening Torque 1.2 Nm

## Scope of delivery

Steatite socket with stainless steel components

Enclosed:

- 1 x tapping screw
- 1 x toothed disc

Figure 2: Dimensions in mm and further technical data